

1RC1025 - 1/18 Asphalt Truck Conversion Kit - Instruction Sheet

Step 1

Start by removing the Body, Tires and Wheels off the base car you will be using and set those parts aside. Next remove all the items shown below. Set all the hardware aside, you will use some of that hardware later in the assembly process. The parts you will not need any longer are the Front Bumper, Front Body Mount, Rear Body Mount and Center Body Mount, Window Net and the two Rear Cage Downbars from the Center Cage assembly.

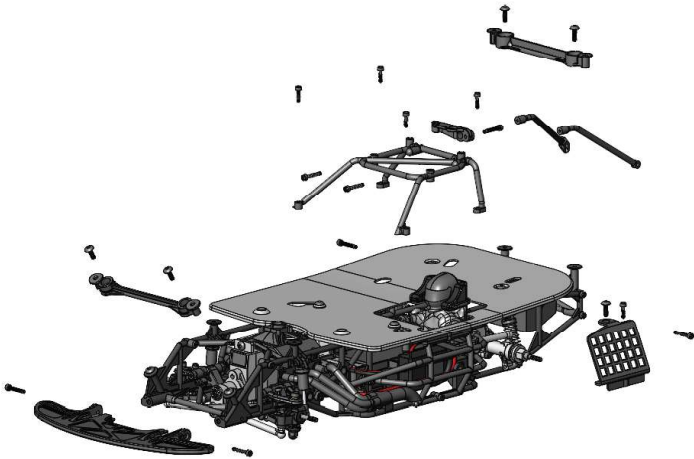

Step 2

Next remove the Body Inner Panel, Driver Figure and Top Center Cage Mount. Set all the hardware aside, you will use some of that hardware later in the assembly process. The parts you will not need any longer are the Body Inner Panel and Top Center Cage Mount.

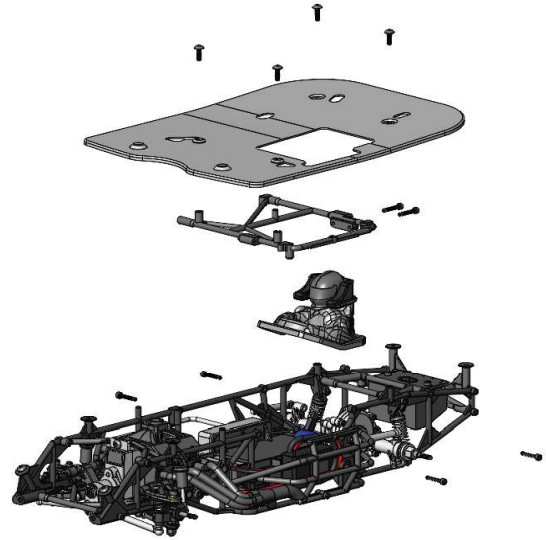

Step 3

Next, using the new Top Center Cage Mount that came with this conversion kit, attached the Driver Figure to the Top Center Cage Mount using the two M1.6 x 10mm screws you removed from Step 2. Now install that assembly into the Chassis and secure using four of the M1.6 x 10mm screws you removed from Step 2 and one M1.6 x 6mm screw on the left side that will secure the Center Cage Mount to the Left Side Chassis.

Next install the Front Bumper as shown and use the two M1.6 x 10mm screws you removed from the Front Bumper in Step 1.

Next, install the two Cage Spacers where the Rear Cage Downbars you removed from Step 1 were located into the rear part of the chassis, note the thicker of the two Cage Spacers will go on the right side of the car. Secure those Spacers using two of the M1.6 x 10mm screws you removed in Step 1.

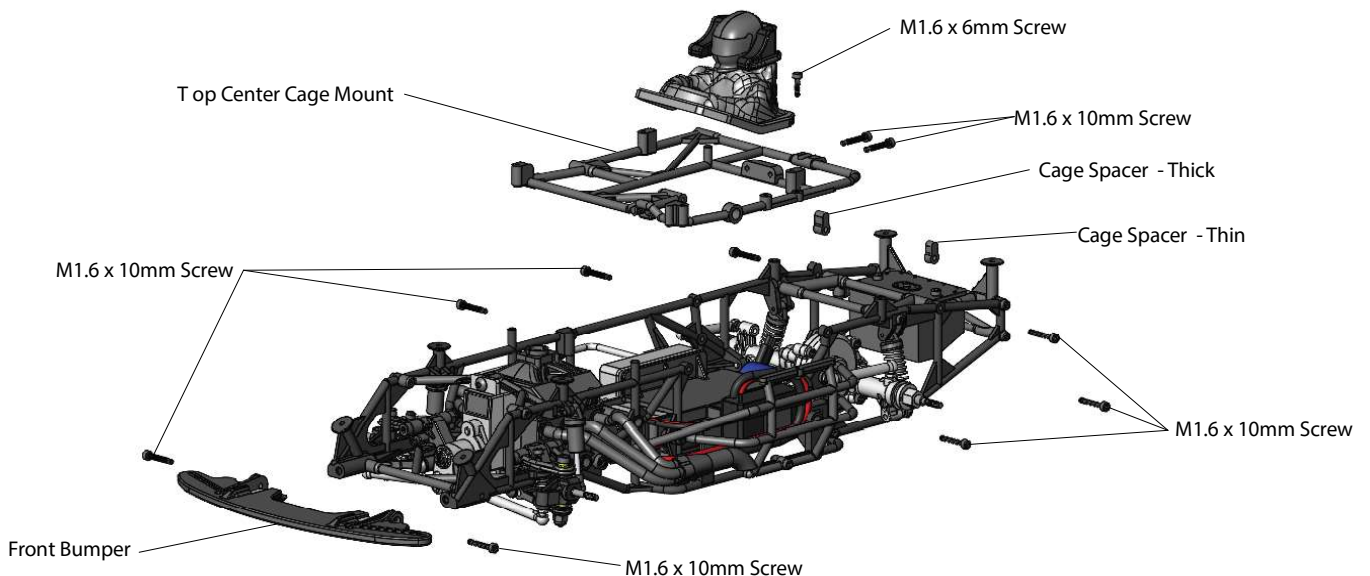

Step 4

Next, position the new Inner Body Panel on the chassis assembly and then place the Center Cage Assembly on top of the Inner Body Panel and secure using four of the M1.6 x 6mm screws you removed from Step 1. You will also need to re-install the one M1.6 x 6mm screw that secures the right side of the back Cage Hoop to the Top Cage Bars that your removed on Step 1 that held on the old Center Body Mount.

Next, install and secure the Window Net that came with the Conversion Kit as shown using one of the M1.6 x 6mm screws to secure the bottom of the Window Net to the Center Cage Mount and one M2 x 6mm screw to secure the top of the Window Net to the top of the Center Cage Assembly.

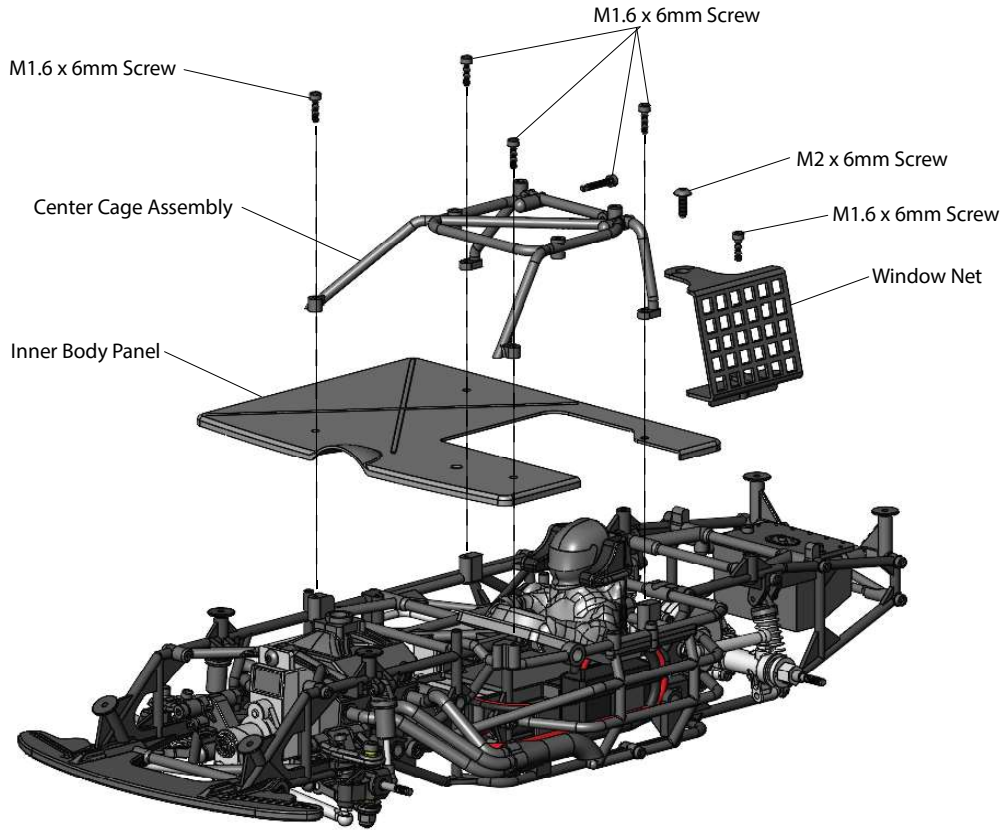

Step 5

Next install the two Rear Down Bars into the holes at the top of the rear window of the Main Body and then secure these to the truck bed using two M1.6 x 6mm screws.

Now install the Rear Spoiler to the Main Body using three of the M2 x 6mm screws and three of the Triangle Plastic Nuts as shown below.

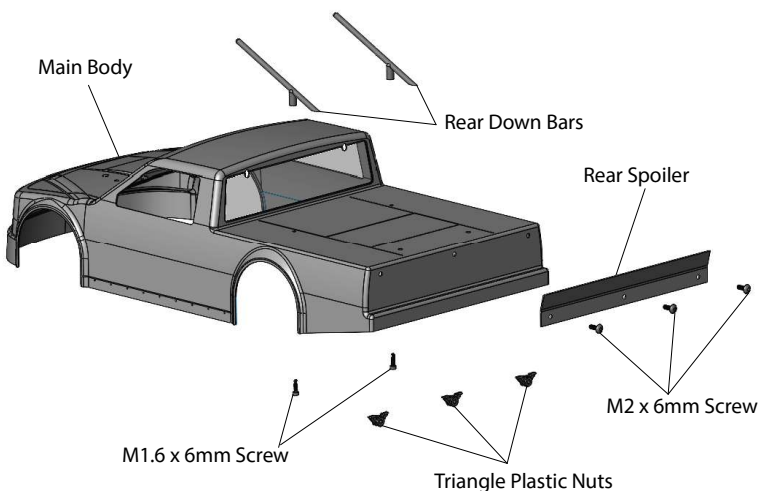

Step 6

Next install the Main Body Assembly from Step 5 to the Chassis using four of the M2 x 6mm screws as shown below. Then install the Tires and Wheels you removed from Step 1 and the assembly is complete.

